



**NATIONAL
CHAMPIONSHIP**
BAY AREA

GAME DAY GUIDE

LEVI'S® STADIUM **SANTA CLARA, CA**

MONDAY **JANUARY 7, 2019**

IMPORTANT INFORMATION

AUTOMOBILE ASSISTANCE

T: 408-579-4600

EMERGENCIES

T: 408-986-4828

Or text **"SUPPORT"** and a message that includes a description of the issue and the location to **69050**

FIRST AID

Main Concourse: Section 122

Upper Concourse: Section 323

SAP Tower Atrium

GUEST SERVICE STATIONS

- **Section 101/102**
- **Section 105/106**
- **Section 107/108**
- **Section 123/124**
- **Section 130/131**
- **Section 309/310**

GUEST SERVICES HOTLINE

T: 408-673 -2100

(Game Day Only)

GUEST TEXT

MESSAGING SERVICE

Text **"SUPPORT"** and a message that includes a description of the issue and the location to **69050**. Report any inappropriate or suspicious behavior.

LOST AND FOUND

T: 408-673-2180

lostandfound@levisstadium.com

LOST AND MISSING PERSONS

T: 408-579-4600

VTA

T: 408-321-2300

ACE

T: 209-944-6220

CAPITOL CORRIDOR

T: 877-974-3322

CALTRAIN

T: 800-660-4287

STADIUM 24/7 SECURITY

T: 408-986-4828

T: 408-579-4600

(Game Day Only)

TICKET QUESTIONS

T: 469-706-9010

tickets@collegefootballplayoff.com

TOWING SERVICE

T: 408-579-4600

WHEELCHAIR ASSISTANCE

T: 408-579-4610

mobilityservices@levisstadium.com

CONTENTS

| | |
|---------------------------------|----|
| WELCOME TO LEVI'S® STADIUM | 4 |
| ALLSTATE CHAMPIONSHIP TAILGATE | 6 |
| GAME DAY SCHEDULE | 7 |
| PARKING AND TAILGATING POLICIES | 8 |
| SECURITY AND BAG POLICIES | 17 |
| EXTRA YARD FOR TEACHERS | 20 |
| PLAYOFF GREEN | 22 |
| LEVI'S® STADIUM | |
| STADIUM INFORMATION | 26 |
| TICKETS | 29 |
| SEATING MAP | 32 |
| ALCOHOL POLICY | 34 |
| WHAT CAN I BRING? | 35 |
| GUESTS WITH DISABILITIES | 38 |
| FOR PARENTS AND CHILDREN | 41 |
| CFP MERCHANDISE | 42 |

WELCOME TO LEVI'S® STADIUM



FUN FACTS

- **August 2, 2014** – First Event: *San Jose Earthquakes vs. Seattle Sounders*
- **August 17, 2014** – First Game: *Preseason 49ers vs. Broncos*
- **September 14, 2014** – First Regular-Season Game: *49ers vs. Bears*
- **Seating Capacity for 2019 National Championship Game:** 68,500
- Levi's® Stadium is home to over 200 original pieces of art and more than 500 original historic photographs.
- Levi's® Stadium was recently awarded the **2017 Facility of Merit** by the NFL and the National Center for Spectator Sports Safety and Security.

SUSTAINABILITY

1,162 SunPower photovoltaic panels are accounted for throughout Levi's® Stadium.

Three solar array-covered bridges, the NRG Energy Bridges, are the first of their kind in the NFL.

The NRG Solar Terrace has a 27,000-square-foot “green roof.” This living roof features 16 species of vegetation native to the Bay Area to lower the building’s cooling and heating needs.

The Faithful Farm is the first-ever rooftop farm located at an NFL stadium. The 7,000 square-foot rooftop farm located on the NRG Solar Terrace supports nearly 40 rotational crops and contributes to the stadium’s efforts with Hunger at Home and the Salvation Army.

LEED Gold Certification for New Construction, the recognized standard for measuring sustainability for design and construction, was awarded to Levi's® Stadium making it the first professional football stadium to open with such a certification.



HOME TO

**San Francisco
49ers**

Redbox Bowl

**Pac-12
Championship Game**

MAJOR EVENTS HOSTED

Levi's® Stadium is a premier outdoor destination for sports and entertainment. Hosting nearly 90 major events to date, including:

- **October 24, 2014** –
First Pac-12 Football Game:
Cal vs. Oregon
Attendance: 55,575
- **November 23, 2014** –
Copa America:
USMNT vs. Colombia
Attendance: 67,439
- **November 27, 2014** –
International Soccer:
Mexico vs. Chile
Attendance: 67,175
- **February 21, 2015** –
NHL: *San Jose vs. Los Angeles*
Attendance: 70,205
- **March 29, 2015** –
WrestleMania 31
Attendance: 76,976

- **June 27, 2015** –
Grateful Dead Concert
Attendance: 75,496
- **June 28, 2015** –
Grateful Dead Concert
Attendance: 74,947
- **July 25, 2015** –
ICC: *Manchester United vs. FC Barcelona*
Attendance: 68,416
- **August 14, 2015** –
Taylor Swift Concert
Attendance: 52,479
- **December 5, 2015** –
Pac-12 Championship:
Stanford vs. USC
Attendance: 55,575
- **February 7, 2016** –
Super Bowl 50
Attendance: 71,088
- **June 18, 2016** –
Copa America:
Mexico vs. Chile
Attendance: 70,547
- **2017 CONCACAF Gold Cup**
Capacity: 68,500

2019 NATIONAL CHAMPIONSHIP

JANUARY 7 | BAY AREA

ALLSTATE CHAMPIONSHIP TAILGATE



Welcome to the Bay Area's biggest party of the year, the Allstate Championship Tailgate!

Open from 10 a.m. – 4 p.m. before the National Championship game at Levi's® Stadium, the Allstate Championship Tailgate is free for all ticket holders. Fans will enjoy interactive games, sponsor activations, concessions, ESPN shows, merchandise and live musical performances. From zip lines to BBQ, marching bands to Grammy Award winning stage performances...the Allstate Championship Tailgate is the one party you cannot miss!

2019 NATIONAL CHAMPIONSHIP

JANUARY 7 | BAY AREA

GAME DAY SCHEDULE

P A C I F I C S T A N D A R D T I M E

10 a.m. **Allstate Championship Tailgate**
WEST OF STADIUM
IN GREEN LOT 1 SOUTH

10 a.m. **Box Office /**
Ticket Windows Open
GATE F, NORTHEAST SIDE

2 p.m. **Stadium Doors Open to Public**

4 p.m. **Pregame Show**
LEVI'S® STADIUM FIELD

5 p.m. **2019 National**
Championship Game
LEVI'S® STADIUM (ON ESPN)

2019

NATIONAL CHAMPIONSHIP

JANUARY 7 | BAY AREA

2019 NATIONAL CHAMPIONSHIP

JANUARY 7 | BAY AREA

PARKING AND TAILGATING POLICIES

BICYCLE POLICIES

Complimentary bicycle valet service is located in Red Lot 1. Bicycle valet will be open three hours prior to the event until one hour after completion of the game. Unattended bicycles that impede pedestrians are subject to removal and/or relocation. Levi's® Stadium and/or its agents shall not be responsible for fire, theft, damage or loss to bicycles or any other article left behind. Levi's® Stadium encourages all bicyclists to use the bike valet and/or the bicycle storage locations provided.

Bicycle routes leading to Levi's® Stadium are accessible from the following trails and/or roadways:

- San Tomas Aquino Creek Trail
- John W. Christian Greenbelt Trail/Prescott
- Guadalupe River Trail
- Great America Parkway
- Lafayette Street
- Tasman Drive/Great Mall Parkway/Capital Avenue
- North First Street

Bicycle traffic on the San Tomas Aquino Creek Trail will be diverted in order to ensure the integrity of the stadium's security perimeter. This temporary path diversion will send north-bound traveling bicyclists east along Agnew Road, north along Lakeshore Drive, east along Gianera Street, north along the off-street pedestrian and bicycle path at the Gianera Street terminus, north through the VTA Parking Lot, northwest along Stars and Stripes Drive, south along Centennial Boulevard, and west along Tasman Drive, where bicyclists will be able to find the bike valet locations.

RV PARKING

RV parking is available on game day for \$200. RVs, buses and campers are not permitted to stay on any stadium property overnight. For overnight parking, please visit www.collegefootballplayoff.com/parking.

BUS AND LIMOUSINE PARKING

To those traveling in buses and limousines, parking is available in Blue Lot 1 for \$200 and \$150, respectively.

DIRECTIONS FOR BUSES**From I-880**

- Take westbound CA 237 or northbound US 101. Then, follow directions below.

From US 101

- Take Lawrence Expressway northbound and turn right on Tasman Drive.
- Turn right on Patrick Henry Drive. The entrance to the parking area will be on your left, past Democracy Way.

From CA 237

- Take Lawrence Expressway southbound and turn left on Tasman Drive.
- Turn right on Patrick Henry Drive. The entrance to the parking area will be on your left, past Democracy Way.

DROP-OFF/PICK-UP AREA

The Levi's Stadium guest drop-off area is located on Great America Parkway, between Tasman Drive & Old Glory Lane. Follow staff and signage to designated area.

For vehicular access, the drop-off location can be accessed via US 101 or CA 237 using the Great America Parkway exit. The Levi's Stadium pick-up location is in Red Lot 7. Vehicular access should utilize Lafayette Street to Great America Way for access to Red Lot 7.

For directions to and from Levi's® Stadium for walking guests from the drop-off and pick-up location, please use the directions below:

TO ACCESS LEVI'S® STADIUM FROM GREAT AMERICA PARKWAY

Walk toward Levi's® Stadium via the pedestrian path through Green Lot 1, located at Old Glory Lane & Great America Parkway.

TO ACCESS THE PICK-UP LOCATION FROM LEVI'S® STADIUM

Guests should exit Gate A and continue on Tasman Drive until you reach Great America Parkway. Once you've reached the intersection, turn right to head north until you reach Red Lot 7, located on the right-hand side. Red Lot 7 is located at Great America Parkway & Old Mountain View Alviso intersection. Due to heavy game egress, it is recommended that guests take public transportation or rideshare to a pre-determined offsite location where guests can more easily meet those returning for passenger pick-up after the game.

GAME DAY PARKING FEES

Parking can be purchased by visiting:

www.collegefootballplayoff.com/parking

- **Standard Vehicles:** \$60 each
- **Limousines:** \$150 each
- **RVs:** \$200 each
- **Buses:** \$200 each

LOT OPENING TIMES

The 2019 national championship game kicks off at 5 p.m. PT. Public parking lots will open at 10 a.m.

Please do not try to access your lot earlier than the listed time or you will not be allowed to park.

PARKING POLICIES

The failure of any guests to obey the instructions, directions or requests of event personnel, stadium signage or management's rules and regulations may cause ejection from the event parking lots at management's discretion, and/or forfeiture and cancellation of the parking pass, without compensation.

AUTOMOBILES AND MOTORCYCLES

- Parking lots associated with Levi's® Stadium are scheduled to open at 10 a.m.
- Parking lots are designated by pass, color and lot number. Guests are encouraged to adhere to posted signs and instructions from event personnel.
- All guests must be in possession of a valid event ticket, pass, or credential to park in a designated parking lot.
- Parking spaces are not pre-assigned. Levi's® Stadium guests who arrive within the first hour of the parking lots being open will be allowed to park freely within the designated lot. Those arriving thereafter will be directed to open spots by lot personnel. A limited number of spaces may be sold the day of the event on a first-come, first-serve basis. Reserving spaces is NOT permitted.
- The parking pass allows for one space per vehicle only, and will be limited to vehicles measuring less than 17' in length and 8' in width.
- Vehicles measuring more than 17' in length and/or 8' in width are required to park in the designated oversized vehicle/RV parking area in Blue Lot 1 (if space allows).
- Refunds will not be made for lost, stolen, or unused parking passes.
- Unauthorized vehicles or vehicles failing to park in the designated areas will be towed and stored at the owner's expense.

- Tailgating is permitted in specified areas only. Non-compliance may result in ejection from the lot without compensation. Tailgating is defined as; the use of any item (including tables, chairs, free-standing canopies or umbrellas, awnings attached to recreational vehicles, coolers, barbeques, grills, games, generators, televisions, sound systems, food or drink, food or drink preparation or serving equipment, or other items as identified by the City Manager or designee) for the purpose of an outdoor gathering by one or more people prior to, during or after a scheduled stadium event.
- Each parking space must be used for vehicle parking only. Spaces may not be used for tailgating.
- Glass containers are not permitted in ANY lot.
- Self-contained campers must park in the designated oversized vehicle/RV parking area.
- The stadium manager or its agents shall not be responsible for fire, theft, damage or loss to vehicles or any other article left in stadium-affiliated parking lots.
- Event parking lots are subject to closure without notice.

RIDESHARE

Guests utilizing Rideshare for pick up post-game should exit out of Gate A. Upon exiting, continue away from the stadium on Tasman Drive. At Great America Parkway, turn right to walk north to Red Lot 7. Once you have reached Red Lot 7, please submit your ride request through your designated app.

PUBLIC TRANSPORTATION

Guests are encouraged to take public transportation. For additional information, visit **www.levisstadium.com**.

VALLEY TRANSPORTATION AUTHORITY (VTA)

VTA light rail trains will drop-off and pick-up at the Great America Station, located north of the stadium. For more information, please visit **www.vta.org** or call 408-321-2300.

VTA BUSES WILL DROP OFF GUESTS IN TWO LOCATIONS

- Intersection of Tasman Drive and Great America Parkway
- Intersection of Tasman Drive and Calle Del Sol

ALTAMONT CORRIDOR EXPRESS (ACE)

ACE Trains provides services to Levi's® Stadium from Stockton, Lathrop/Manteca, Tracy, Vasco, Livermore, Pleasanton and Fremont. For more information, please visit **www.acerail.com** or call 209-944-6220.

CAPITOL CORRIDOR

Capitol Trains provides services to Levi's® Stadium from Auburn, Rocklin, Roseville, Sacramento, Davis, Suisun/Fairfield, Martinez, Richmond, Berkeley, Emeryville, Oakland, Hayward and Fremont/Centerville. For more information, please visit **www.capitolcorridor.org** or call 877-974-3322.

CALTRAIN

Caltrain provides services from San Francisco to South San Jose with stops all along the peninsula.

On event day, Caltrain transports passengers from all locations to connect with VTA light rail trains or buses at the Mountain View Transit Center, located at Evelyn Ave and Castro Street. For more information, please visit **www.caltrain.com** or call 800-660-4287.

TAXIS

Taxis can be picked up in Red Lot 7, same lot as Rideshare.

AUTOMOBILE ASSISTANCE

For automobile assistance in the parking lots, call the stadium command post at 408-579-4600. Please raise your car hood and/or notify an officer at any lot entrance.

PARKING LOCATIONS



2019 NATIONAL CHAMPIONSHIP

JANUARY 7 | BAY AREA

TAILGATING

Tailgating is defined as the use of any item (including tables, chairs, free-standing canopies or umbrellas, awnings attached to recreational vehicles, coolers, barbeques, grills, games, generators, televisions, sound systems, food or drink, food or drink preparation or serving equipment, or other items as identified by the City Manager or designee) for the purpose of an outdoor gathering by one or more people prior to, during or after a scheduled stadium event.

- Tailgating will cease after kickoff.
- All guests must be in possession of a valid game ticket or credential.
- Amplified sound is prohibited.
- Excessive consumption of alcohol is prohibited.
- Tailgating cannot impede vehicle or foot traffic.
- Tailgating is limited to the area directly in front of or behind your vehicle only.
- Empty spaces may not be reserved or used for the purpose of tailgating.
- Tents or canopies exceeding an 8' X 8' footprint are not permitted.
- Appropriate receptacles must be used for the disposal of hot coals.
- All Guest Code of Conduct and parking policies are in effect.

TOWING SERVICE

Unique Towing provides complimentary services to stranded motorists in Levi's® Stadium lots. These services are available to all guests and include recharging drained batteries, changing flat tires and lockouts. Additional services will be available per guest request at their expense. The services will be available on site beginning three hours prior until one hour after the completion of the game. If services are needed, please contact 408-579-4600.

APPROVED BAGS



CLEAR PLASTIC BAG

12" x 6" x 12" or smaller



CLEAR BACKPACK

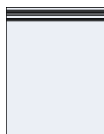

1-GALLON PLASTIC FREEZER BAG



CLEAR PURSE



CLEAR FANNY PACK



CLUTCH WITH SHOULDER STRAP

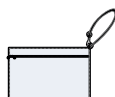

CLUTCH WITH WRIST STRAP

No larger than 4.5" x 6.5"

EXCEPTION: Fans with medical bags or items they must carry with them must be inspected and either have a wristband or sticker placed on it to show that it has been inspected.

NON-APPROVED BAGS

NO BAGS LARGER THAN 12" X 6" X 12"



PURSE



PRINTED PATTERN PLASTIC BAG



SEAT CUSHION WITH POCKET



CAMERA CASE



BINOCULARS CASE



TINTED PLASTIC BAG



OVERSIZED TOTE BAG



BACKPACK



FANNY PACK



MESH BAG

SECURITY AND BAG POLICIES

To enhance public safety, Levi's® Stadium and the College Football Playoff have created the following security policies for the 2019 College Football Playoff National Championship.

THE FOLLOWING ENTRY POLICIES WILL BE IN EFFECT AT LEVI'S® STADIUM

BAG POLICY

In compliance with Levi's® Stadium Bag Policy, the College Football Playoff prohibits all bags, backpacks and other carriers from being brought into the stadium with the following exceptions:

- CFP-approved clear plastic bags (12" X 6" X 12")
- One-gallon clear plastic resealable bags
- Small clutch bag (4.5" X 6.5")

All approved bags are subject to inspection upon entry and are subject to additional inspections within the stadium.

Guests with oversized bags must return their bags to their vehicle or check these bags at the bag valet. The bag valet will only accept empty bags. The contents of guests bags must be emptied into a clear bag and carried into the stadium. The bag valets are located near Gate 5, Gate 1, or Gate F. These locations open at 10 a.m. and will close one hour after the completion of the game.

BAG TAGS

Any previous bag tags will need to be removed prior to inspection. Only the game day bag tag for the stadium will be permitted.

CLEAR BAGS

Complimentary CFP-branded bags will be distributed around the stadium perimeter at the following locations on game day:

BAG VALET LOCATIONS AND HOURS

- **Near Gate F:** 10 a.m. – one hour post-game
- **Near Gate 1:** 10 a.m. – one hour post-game
- **Near Gate 5:** 10 a.m. – one hour post-game

PROHIBITED ITEMS

All individuals and their belongings are subject to search. The following information is subject to change without notice. Fans with medical bags or items that they must carry with them must be inspected and either have a wristband or sticker placed on it after inspection. Please arrive earlier to avoid last-minute gate pressure.

THE FOLLOWING ARE PERMITTED IN THE STADIUM

- Bags that comply with the Bag Policy (see Bag Policy on pages 16–17)
- Binoculars shorter than six inches (case prohibited)
- Blankets
- Cameras with three inch lenses or shorter (no lights, tripods, selfie sticks or monopods)
- Diaper bags accompanying a child
- Flags smaller than 2' X 3' (no poles)
- Food and fruit (must be cut into pieces)
- Plastic water bottles (factory-sealed, no alcohol, less than 24 ounces)
- Reusable, transparent water bottles (no alcohol, less than 24 ounces)
- Seat cushions
- Strollers (must be stored at a Guest Services Station – see list of locations on page 2)
- Sunscreen & hand-powered misters
- Umbrellas (no obstruction of other fans view)

THE FOLLOWING ARE PROHIBITED IN THE STADIUM

- Aerosol cans
- Alcoholic beverages
- Bags that violate the Bag Policy (see Bag Policy on pages 16–17)
- Cameras with lenses larger than three inches (lights, tripods, selfie sticks and monopods are also prohibited)
- Cans and glass bottles
- Drugs, drug paraphernalia, marijuana and marijuana products
- Coolers (including soft-sided coolers)
- Glow sticks, light-up costumes, light-up signs, battery packs
- Klaxons, bullhorns, whistles or any other noisemakers
- Laptops and laptop bags
- Laser pointers of any type
- Offensive clothing
- Plastic bottles larger than 24 ounces
- Projectiles (footballs, Frisbees, etc.)
- Selfie sticks
- Signs, banners or poles
- UAVs (unmanned aerial vehicles)
- Weapons of any kind (including silverware)

Anyone possessing PROHIBITED items will be asked to return them to their cars or dispose of them in the garbage cans provided at the gate.

CODE OF CONDUCT AND VIOLATIONS RESPONSE PROTOCOL

Levi's® Stadium is dedicated to providing a high-quality entertainment experience. Guests who interfere with play, use foul language, make obscene gestures, smoke, or appear to be impaired, may be ejected. Levi's® Stadium has adopted an escalating scale of enforcement for Guest Code of Conduct violations. The purpose of this policy is to help ensure that all Levi's® Stadium guests enjoy a positive game day experience.

ENTERING THE PLAYING FIELD

Guests are reminded that attempting to enter or access the playing field without the proper credentials will be considered trespassing, which is grounds for immediate ejection and arrest.



COLLEGE FOOTBALL PLAYOFF
FOUNDATION



EXTRA YARD
FOR TEACHERS

CHAMPIONING GREAT CLASSROOM LEADERS

The College Football Playoff (CFP) Foundation is the philanthropic arm of the College Football Playoff, supporting education across the country.

Extra Yard for Teachers is the CFP Foundation's primary platform that is dedicated to elevating the teaching profession by inspiring and empowering teachers in four focus areas: **resources, recognition, recruitment and professional development.**

2019 NATIONAL CHAMPIONSHIP

JANUARY 7 | BAY AREA

PROJECTED IMPACT



\$25 MILLION
in support of
education



175,000
teachers
supported



5 MILLION
students reached



25,000
schools
benefited



Our 10-year goal is to engage
1 MILLION TEACHERS

In conjunction with the College Football Playoff, the CFP Foundation recognizes the State Teacher of the Year from each U.S. state and territory as part of the Teacher of the Year Championship Experience presented by Dr Pepper, a program hosted during this special weekend.

The 2018 National Teacher of the Year, Mandy Manning (Washington), has spent the last year traveling the nation to represent educators and will join the CFP Foundation in the Bay Area for the national championship game. Manning and her fellow State Teachers of the Year, sitting in section 132, will be honored in Levi's® Stadium prior to kickoff.

To learn more about the CFP Foundation, visit:

www.cfp-foundation.org

and follow **@CFPEXtraYard** on social media.

PLAYOFF GREEN

Levi's® Stadium is working to achieve zero waste and we need your help. Please place all plastic and aluminum bottles and cans in the recycling containers labeled "Bottles and Cans." We recycle paper, cardboard and scrap metal, and compost food waste throughout our operation. Recycling lessens the impact on the environment and saves resources.

Supporting a clean environment, the College Football Playoff practices a number of unique sustainability projects to "green" the national championship game and to encourage others in the college football family to do the same.



2019 NATIONAL CHAMPIONSHIP

**KEY INITIATIVES HAVE BEEN DEVELOPED AROUND
THE 2019 COLLEGE FOOTBALL PLAYOFF
NATIONAL CHAMPIONSHIP, INCLUDING:**

SOLID WASTE RECYCLING at major event venues, including the San Jose McEnergy Convention Center, site of Playoff Fan Central, and at Levi's® Stadium, site of the 2019 College Football Playoff National Championship. Look for "Green Ambassadors" in the stadium, helping fans recycle on game day.

PREPARED FOOD RECOVERY from all events that serve food to fans. Through a partnership with the local food banks, food that is cooked in the kitchens but never served will be recovered safely and provided to those in need in the greater Bay Area.

MATERIAL REUSE AND REPURPOSING is an important strategy to keep material out of landfills. Construction materials, décor and other event materials will be donated to local organizations for reuse and repurposing in the community, instead of going to waste.

RENEWABLE ENERGY CERTIFICATES provide a way to reduce greenhouse gas emissions and address their impact on climate change. Stadium and downtown Championship Campus events will be "green" and powered through the use of renewable energy certificates (RECs).

PLAYOFF GREEN CAMPUS CHALLENGE is the exciting initiative bringing sustainability to local Bay Area school campuses. Select schools have been challenged to implement a series of sustainability projects on their campuses. When successfully completed, the participating schools will be awarded grants for school supplies and for "green" initiatives.



NATIONAL CHAMPIONSHIP

BAY AREA 2019



STADIUM INFORMATION

ATMS

ATMs are located inside and outside Levi's® Stadium, including:

- Lower Concourse Sections 113 and 117
- On top of the Dignity Health Plaza next to the team store
- Upper Concourse Section 308

COMPLIMENTS, CRITICISMS, AND COMMENTS

Levi's® Stadium encourages guests to provide feedback on their stadium experience to any Levi's® Stadium Playmaker by visiting one of the Guest Services Stations located in various locations throughout the stadium concourse, by email at guestservices@LevisStadium.com or by visiting www.LevisStadium.com

ELEVATORS AND ESCALATORS

There are 38 escalators and 25 elevators located within Levi's® Stadium:

- Entry at Gate A, Gate C and Gate F

ENTRANCES

Stadium doors will be open to the public at 2 p.m.

FIELD ACCESS

Access to the field is not permitted to guests of Levi's® Stadium without proper credentials.

FIRST AID

There are three First Aid locations at Levi's® Stadium:

- Main Concourse Section 122
- Upper Concourse Section 323
- SAP Tower Atrium

FOOD AND BEVERAGE

For all events, food may be brought into Levi's® Stadium, as long as it is placed in clear plastic wrapping or bags that comply with the Levi's® Stadium Bag Policy. Fruit must be cut into smaller pieces. Only water in a factory sealed plastic bottle, 24 ounces or less, is permitted into the perimeter.

GUEST SERVICES

Guest Service Stations are located throughout Levi's® Stadium and can be used to assist any guest to solve a myriad of issues. Guest Service Stations can be found in the following locations:

- Section 101/102
- Section 105/106 on the outer perimeter of the main concourse
- Section 107/108
- Section 123/124
- Section 130/131 on Dignity Health Plaza
- Section 309/310 on the outer perimeter of the main concourse

HAPPY OR NOT TERMINALS

Happy Or Not Fan terminals are located at concession stands, retail stores, restrooms, and other locations throughout the stadium to gather real-time fan satisfaction scores. Fans simply press any of the four options on the terminal, from Very Happy to Very Unhappy, to deliver their feedback. Levi's® Stadium staff use the ratings to diagnose and resolve issues during the game in order to deliver the best fan experience possible.

LOST AND FOUND

Guests who find items are encouraged to turn them over to any Guest Services Station. Guests may also visit any Guest Services Station during the event to claim lost items. To contact Lost and Found please call 408-673-2100 or email lostandfound@levisstadium.com.

RE-ENTRY POLICY

Re-entry is not permitted at Levi's® Stadium for the national championship game. In case of emergency, guests can contact the ticket taker and/or security supervisor at the nearest gate.

RESTROOMS

There are public restrooms for men, women and families conveniently located on all levels of the stadium. All restrooms are accessible to guests with disabilities.

MEN'S

- **Main Concourse:** Sections 103, 107, 110, 120, 123, 125, 233 and 245
- **Upper Concourse:** Sections 302, 306, 311, 318, 322 and 327
- **Suites:** Citrix Owners Club 1 and 21
- **Black Oak Casino Resort Club:** 4, 16, 35 and 48
- **SAP Tower:** Sections 506, 530, 606, 630, 706 and 707
- **Clubs:** Yahoo! Fantasy Football Lounge, Levi's® 501 Club, United Club, East Field Club and IdentoGo Green Room
- **Other:** Bourbon Steak & Bourbon Pub, 49ers Museum, Press Level and NRG Solar Terrace

WOMEN'S

- **Main Concourse:** Sections 101, 106, 108, 110, 120, 123, 125, 127, 233 and 245
- **Upper Concourse:** Sections 303, 308, 312, 317, 321 and 326
- **Suites:** Citrix Owners Club 1 and 21
- **Black Oak Casino Resort Club:** 4, 16, 35 and 47
- **SAP Tower:** Sections 504, 530, 604 and 630
- **Clubs:** Yahoo Fantasy Football Lounge, Levi's® 501 Club, United Club, East Field Club and IdentoGo Green Room

For family restrooms locations, refer to page 41.

SMOKING

In accordance with the Santa Clara City Ordinance, Levi's® Stadium is a smoke-free facility, which includes, but is not limited to, cigarettes, vapor cigarettes, electronic cigarettes and joints. Designated smoking areas have been established at select location(s) within the stadium perimeter.

TICKETS

ACCESSIBLE SEATING

A limited number of accessible seats may be available for exchange on game day. Guests wishing to exchange their seats for accessible seating should enter Gate F at the northeast side of the stadium and proceed to the Box Office for assistance. For more information on accessible seating, please call Box Office at 408-579-4449.

AUTHORIZED TICKET DISTRIBUTORS

The College Football Playoff, including its sponsors and stakeholders, Playoff Premium, the Bay Area Host Committee, CFP-RSVP, Ticketmaster (Fan-to-Fan Ticket Exchange) and participating teams and conferences, are authorized ticket distributors. All persons are advised to purchase tickets only from authorized ticket distributors.

BOX OFFICE/TICKET RESOLUTION

Box Office windows are located near Gate F of Levi's® Stadium on the northeast side of the stadium and will open at 10 a.m. on game day.

CLUBS AND CLUB SEATS

Premium club areas are located throughout Levi's® Stadium. Club seat holders have access to the clubs indicated on their ticket and all general areas of the stadium. Access to one premium area does not necessarily provide access to other similar areas.

PLAYOFF PREMIUM

Game tickets including hospitality, parking and other amenities are available through Playoff Premium. The College Football Playoff and its event experience providers Colonnade Group, Dallas Fan Fares, Elder Sports Marketing, and QuintEvents are the official Playoff Premium providers.

RESALE OF TICKETS

Fans who purchase tickets from someone other than Ticketmaster, CFP-RSVP, or participating institutions and conferences do so at their own risk. These tickets could be counterfeit. The College Football Playoff is not responsible for and will not provide a replacement or refund of any kind for invalid tickets purchased through an unauthorized secondary ticket provider.

SCALPING AND PROFITEERING POLICIES

The unlawful resale of any event ticket on Levi's® Stadium grounds, and/or event parking lots, is strictly prohibited and may result in the loss of ticket privileges and/or prosecution to the full extent of the law.

STUDENT-ATHLETE GUEST TICKET DISTRIBUTION

Student-athlete guests must enter on the west side of Levi's® Stadium, through entry Gate 3, via a pass list starting at 10 a.m.

TICKET POLICY

All individuals, regardless of age, require a ticket for stadium entry. Lap passes are not issued.

TICKET PRICES

Reserved seats are \$475, \$575 or \$675. Club level seats \$775.



**NATIONAL
CHAMPIONSHIP**
BAY AREA 2019



2019 NATIONAL CHAMPIONSHIP

JANUARY 7 | BAY AREA

2019 NATIONAL CHAMPIONSHIP

JANUARY 7 | BAY AREA

ALCOHOL POLICY

No alcohol may be brought into the perimeter of Levi's® Stadium. Alcohol purchased at Allstate Championship Tailgate may be carried into the stadium.

Guests that are intoxicated or are perceived to be intoxicated will be denied entry into Levi's® Stadium. Guests must be 21 years of age or older and in possession of valid government issued identification to purchase, handle, or consume alcoholic beverages at Levi's® Stadium.

There is a maximum of two alcoholic beverages per purchase. All alcohol sales will be discontinued at the end of the third quarter, or earlier at Levi's® Stadium management's discretion.

Guests providing alcohol to minors will be ejected and subject to arrest.

Guests possessing alcohol, who do not have proof of being at least 21 years of age, will be ejected and subject to arrest.

Drunk and disorderly conduct or violation of any alcohol policy will result in ejection from Levi's® Stadium without refund and the violator(s) may be subject to arrest. Excessive consumption of alcohol is prohibited.

Alcohol purchased at Levi's® Stadium is not to be removed from Levi's® Stadium.

Stadium management reserves the right to change policies or procedures at any time without notice.

WHAT CAN I BRING?



ALCOHOL: NO

Alcoholic beverages may not be brought into the perimeter. Any attempt to bring alcohol into the perimeter will be considered a violation of the Code of Conduct and may result in the guest being ejected, arrested or ticket being revoked. Any alcohol purchased within the perimeter or at Allstate Championship Tailgate can be brought into the stadium.



ANIMALS: YES

Only service animals with proper identification are permitted into Levi's® Stadium. All other animals are prohibited.



BANNERS, SIGNS, FLAGS: YES

Guests are encouraged to show their support and may bring hand-held signs, as long as they do not impair the view of other guests and do not contain vulgar, offensive or graphic content. No sign may be of commercial nature. Dry erase boards and signs attached to sticks or poles are prohibited. This policy is subject to change based on CFP or Levi's® Stadium management's discretion and without notice.



BOTTLES AND CANS: NO

Guests will not be allowed to bring any type of bottle, can, thermos or beverage container inside of Levi's® Stadium. Only water in a factory sealed plastic bottle, 24 ounces or less, is permitted into the perimeter.



BOTTLE OF WATER: YES

Fans will be allowed to bring one factory-sealed, non-frozen 500mL (16.9 fl. oz.) bottle of water (no soda flavored water or sports drinks).



CAMERAS AND VIDEO EQUIPMENT: YES

Please be courteous to those around you when taking photos to avoid sightline obstruction of other guests. The following represents our camera and video equipment guidelines (see next page):

- Cameras, zoom lenses (less than 3") and GoPros are permitted.
- Camera bags are prohibited inside Levi's® Stadium.
- Lights may not be used with video-recording equipment.
- Tripods and monopods are prohibited.

Guests may not reproduce or rebroadcast any films or photographs shot at the stadium without the expressed written consent of Levi's® Stadium management.



DIAPER BAGS: YES

Diaper bags accompanying infants/toddlers of diaper-wearing age are permitted if carrying diapers and other items for proper childcare, but are subject to search and will be tagged.



FOOD AND BEVERAGE: NO

Food may be brought into Levi's® Stadium, as long as it is placed in clear plastic bags that comply with the Levi's® Stadium Bag Policy. Fruit must be cut into smaller pieces. Only water in a factory sealed plastic bottle, 24 ounces or less, is permitted into the perimeter.



FORMULA OR MILK: YES

Parents with small children may bring plastic bottles of formula or milk inside the stadium.



MEDIA COMPONENTS: NO

Media components such as mono/tripods, selfie sticks, or professional cameras with zoom lenses greater than three inches are prohibited.



MEDICAL OR DIETARY RESTRICTIONS: YES

Please contact the Guest Services Hotline at 408-673-2100, in advance of game day for a special accommodation letter if you need to bring in items for either of these reasons.



NOISE MAKING DEVICES: NO

No noise-making devices of any kind are permitted inside Levi's® Stadium during the national championship game. Such devices may be allowed at the discretion of Levi's® Stadium Management. Please refer to "Permitted and Prohibited" for further information.



RADIOS WITH HEADPHONES: YES

To ensure all guests can enjoy the event, personal radios/smartphones must be used with headphones inside Levi's® Stadium.



STROLLERS: YES

Strollers are welcome at Levi's® Stadium, but are not allowed to be stored in an aisle or under a seat. Strollers may be checked in at a Guest Services Station located at Sections 101, 130 or 309.



TABLETS: YES

Tablets (e.g., iPads) are permitted if they can be powered on during the security screening (if requested). **Laptop computers are prohibited.**



TOBACCO, E-CIGARETTES AND VAPORIZERS: NO

In accordance with the Santa Clara City Ordinance, Levi's® Stadium is a smoke-free facility, which includes, but not limited to, cigarettes, vapor cigarettes, electronic cigarettes, and joints. Designated smoking areas have been established at select location(s) within the stadium perimeter.



WEAPONS: NO

Guests are not permitted to bring firearms or any other weapons inside Levi's® Stadium, including off-duty law enforcement officials attending the event.

GUESTS WITH DISABILITIES

ADA DIRECTIONS FOR PARKING AND DROP-OFF LOCATIONS

From I-880:

- Take northbound US 101 and follow directions below.

From CA 237:

- Take southbound US 101 and follow directions below.

From US 101 (parking):

- Take Great America Parkway northbound and park within Red Lot 1 for accessible parking.

In addition to our main lot, several outside lots provide parking for guests needing mobility assistance. Courtesy shuttles will run from Blue Lot 1 to the stadium. The same service from the stadium to the two designated lots is provided post-event as well.

While pre-paid passes are for specific parking lots, guests who possess a DMV-issued disabled person parking placard and a DMV-issued disabled person ID card may park in the Main Lot in accessible parking stalls after paying the \$60 parking fee.

ASSISTED LISTENING DEVICES

- Assisted listening devices will be available at all Guest Service stations located throughout the Stadium.
- A valid California driver's license or ID may be required as collateral.
- These listening devices provide closed captioning and video remote interpreting and amplify the stadium's public address announcements, but do not provide service to the play-by-play broadcast.

COURTESY BUSES

One outer parking lot will be serviced by courtesy shuttle buses. This lot is Blue Lot 1 (subject to change depending on lot availability).

These buses will begin running two hours prior to kickoff and will cease 90 minutes after the game has ended.

These buses are for our guests who have mobility limitations and who may not have a handicap placard. Guests who possess a valid handicap placard are strongly encouraged to park in Green Lot 1 or Red Lot 1. There are handicap parking spaces in these two lots and courtesy cart assistance will be available in both.

COURTESY CARTS

The courtesy cart service will be available in Red Lot 1, Green Lot 1, and Yellow Lots 1, 2 and 3.

There will be several Guest Service Stations in these lots that will be staffed by a mobility assistance team member to assist guests. There will be seating for guests at these stations as they await a courtesy cart.

There is limited space on these courtesy carts and we ask that guests not needing extra assistance please respect the needs of others.

CLOSED CAPTIONING

Closed captioning is available for guests at Levi's® Stadium. For more information on closed captioning, please visit one of the Guest Service stations.

DISABILITY SERVICES

Levi's® Stadium takes pride in providing elite service to all guests, including those requiring mobility assistance. We provide a variety of services for our guests with special needs. Included in these services are courtesy shuttle buses from several of our parking lots, golf cart shuttles in the main lot, and Guest Services representatives to provide wheelchair service if requested.

- Levi's® Stadium offers accessible seating, as well as companion seating in many locations. Accessible seating can be coordinated through Levi's® Stadium Box Office at 408-579-4449.
- Guests requesting wheelchair assistance can do so by calling our mobility assistance team at 408-579-4610.

FAMILY RESTROOMS

Private family restrooms are located throughout the stadium on all concourses, club, and suite levels. Family restrooms are equipped with baby changing tables. For family restroom locations refer to page 41. For a list of all other restroom locations please refer to the "Restroom" section on page 28.

GUEST SERVICES HOTLINE

Levi's® Stadium guests are encouraged to report unruly guest behavior by contacting the nearest stadium personnel or by texting keyword **"SUPPORT"** and then a message that includes a description of the issue and the location to **69050**.

SERVICE ANIMALS

Only service animals with proper identification are permitted into Levi's® Stadium. All other animals are prohibited.

WHEELCHAIR ASSISTANCE

- Guests that require additional assistance are encouraged to contact our mobility assistance team at 408-579-4610 or email mobilityservices@LevisStadium.com.
- Wheelchairs are available on a temporary basis. Guests in need of a wheelchair for the entire game should bring their own. Please call or visit the box office to receive an assigned wheelchair seating location.
- Should guests need assistance post-game, members of our mobility services team will be available to assist. For faster service, please contact a Guest Service Representative in your section.

FOR PARENTS AND CHILDREN

BABY CHANGING STATIONS

Baby changing stations are located in all family restrooms throughout Levi's® Stadium. These restrooms can be found on all concourses and on each club and suite level.

DIAPER BAGS

Diaper bags accompanying a child are permitted, but are subject to search and will be tagged.

Levi's® Stadium strongly advises that stickers, a nametag and additional information be pinned to the clothing of young children that may require assistance.

FAMILY RESTROOMS

- **Main Concourse:** Sections 108 and 127
- **Upper Concourse:** Sections 309 and 320
- **Suites:** Citrix Owners Club: 3
- **SAP Tower:** 511, 523, 611, 624, 711, 723
- **Clubs:** Yahoo! Fantasy Football Lounge, Levi's® 501 Club, United Club
- **Other:** Press Level

FORMULA OR MILK

Parents with small children may bring plastic bottles of formula or milk inside the stadium.

GUEST SERVICES

Guest Service Stations are located throughout Levi's® Stadium and can be used to assist any guest to solve a myriad of issues. Guest Service Stations can be found in the following locations:

- Section 101/102
- Section 105/106 on the outer perimeter of the main concourse
- Section 107/108
- Section 123/124
- Section 130/131 on Dignity Health Plaza
- Section 309/310 on the outer perimeter of the main concourse

NURSING STATIONS

- **Atrium South Side**
- **Outer Concourse:** Section 106
- **Outer Concourse:** Section 126

STROLLERS

Strollers are welcome at Levi's® Stadium, but are not allowed to be stored in an aisle or under a seat. Strollers may be checked in at a Guest Services Station located at Sections 101, 130, or 309.

CFP MERCHANDISE

Official national championship game apparel will be available at Levi's® Stadium. Hundreds of items will be available for sale, including items from the Exclusive Stadium Collection, jerseys, t-shirts, hats and novelty items for men, women and youth.

MERCHANDISE/RETAIL LOCATIONS INSIDE THE STADIUM

Official merchandise can be purchased at Championship Tailgate, the Gate A Championship Shop and throughout the stadium on the main concourse, upper concourse and within the clubs.

SOUVENIR PROGRAMS

The College Football Playoff National Championship Official Souvenir Program will be available for purchase at various locations throughout Levi's® Stadium for \$15.

STAY C(=)NNECTED



www.collegefootballplayoff.com



/CollegeFootballPlayoff



@cfbplayoff



@cfbplayoff

#CFBPlayoff

#NationalChampionship

DOWNLOAD
THE OFFICIAL
COLLEGE
FOOTBALL
PLAYOFF APP



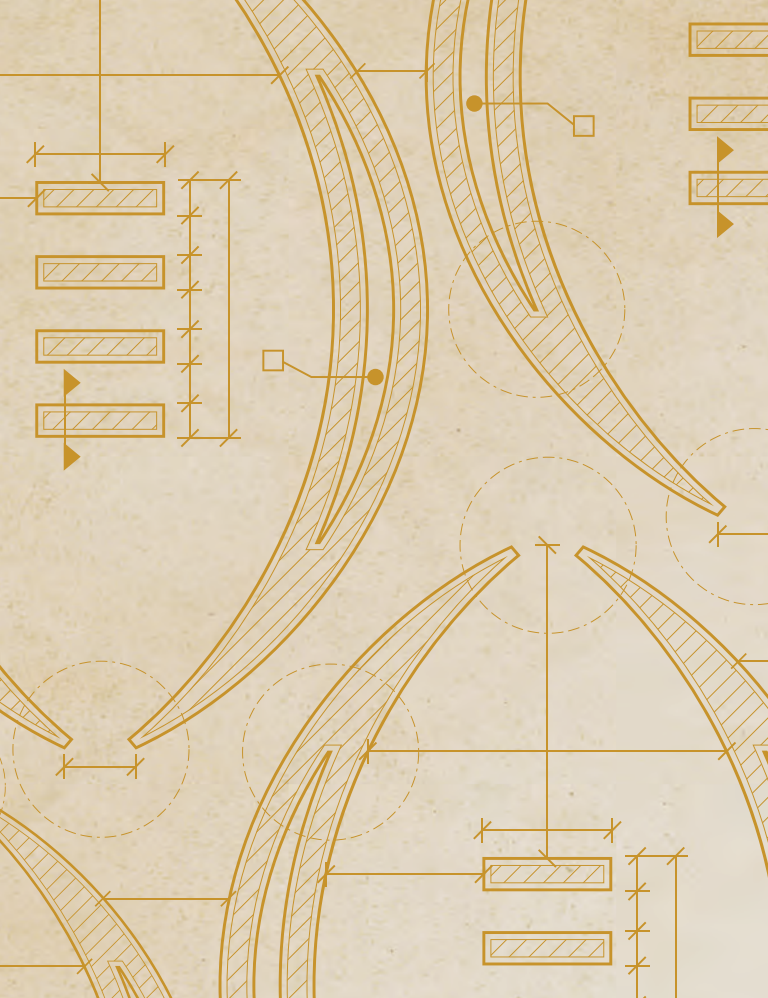



COLLEGE FOOTBALL PLAYOFF

www.collegefootballplayoff.com

 /CollegeFootballPlayoff

 @cfbplayoff

 @cfbplayoff

 #CFBPlayoff